

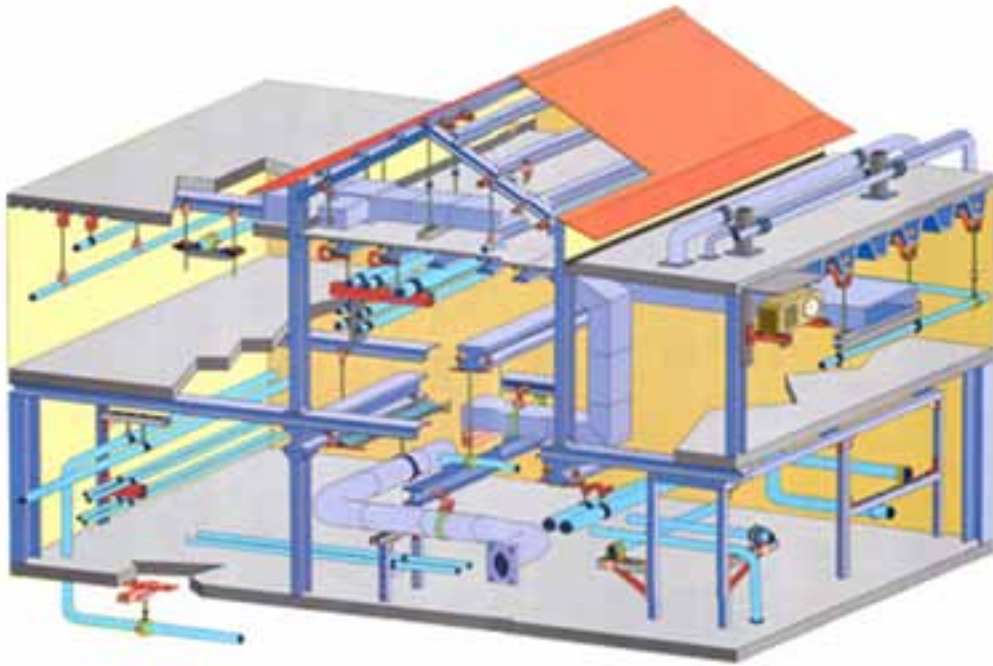

**HVAC DUCT  
HARDWARE  
CATALOGUE**





**Caddy Products "on-site" application examples**

## Contents

Access Panels .....	2
Flange, Slide & Accessories .....	3
Fan Connector & Vane Runner .....	4
Bellmouth Spigots .....	5
Quadrants, Damper Kits & Push Pull Kits .....	6
Hinges & Catches .....	7
CD Pins, Speedclips, Black Buttons & Selfsticks .....	8
CD Accessories .....	9
Sealants, Waffle Pad & Tapes .....	10
Smart Band, Banding & Accessories .....	11
Flex Saddle .....	12
Dust Protection Film .....	13
Slotted Angle & Hanging Brackets .....	14
Purlin Clips, Mounting Plates & Beam Clamps .....	15
Vertigo Hangers .....	16
Masonry Fasteners .....	17
Threaded Rod & Accessories .....	18
Set Screws, Cup Heads & Metal Cutting Discs .....	19
Tek Screws & Drill Bits .....	20
Pop Rivets .....	21
Cantilever Brackets & Kits .....	22- 23
Channel & Accessories .....	24- 26



## Access Panels

Part #	Installation Opening Size		Qty Per Ctn.
82AP4	200 x 125	Hand/Sight	20
82AP3	240 x 150	One Hand & Sight	10
82AP2	375 x 240	Two Hands & Sight	10
82AP1	500 x 370	Head & Shoulders	5
82APO	650 x 500	Body Entry plus Ladder	4



## Flange, Slide & Accessories

### MASTERFIT DUCT CONNECTION FLANGE

Part #	Description	Qty Per Ctn.
82F35	35mm Flange 5.0 Mtr	25
82CF35	Flange Corner 35mm	250
82CTDF	TDF Machine Corner	250/box 5000/crate
82CTDC	TDC Machine Corner	250/box 5000/crate
82CTDC-S	TDC Stackable Corners	250/box 5000/crate
82C150	Snap on Cleat 150mm	250

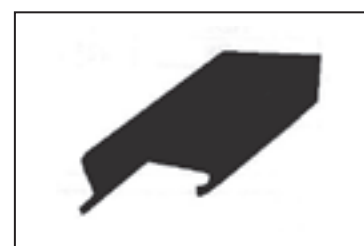

### SLIDES

Part #	Description	Qty Per Ctn.
82SLFD	Flat Side 3 Mtr	10
82SLR	Reinforced Drive Slide 3 Mtr	10
82CSD	Slide Corners	1000

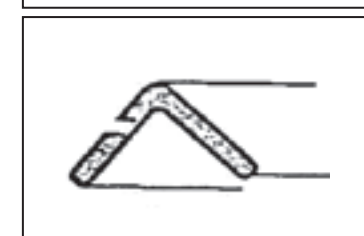
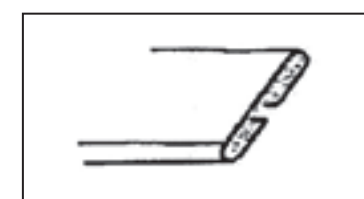

## Fan Connector and Vane Runner

### FLEXIBLE FAN CONNECTOR

Part #	Description	Qty Per Ctn
82FCE	Econoflex Vinyl 100mm x 50mm x 30.5m	1
82FCM	Metalflex 100mm x 80mm x 30.5m	1
82FCXFT	High Temp. 260° 100mm x 98mm x 30.5m	1



### VANE RUNNER / TURNING VANE

Part #	Description	Qty Per Ctn.
82VRS	Vane Runner Single (Roll) x 30.5mtr	1



## Bellmouth Spigots

Available in PLAIN, with EXTERNALLY adjustable damper blade or with INTERNALLY adjustable damper blade.

Designed specifically for fixing flexible duct to rigid steel duct, cushion heads & cool rooms.

Locally manufactured by metal spinning, from Galvabond material gives a unique bell mouth flange for easy fixing to duct work.



### SIZE – DIAMETER

150mm

200mm

250mm

300mm

350mm

400mm

450mm

When ordering spigots please denote the following 81

“S” then size for Plain,

“SDA” then size for Spigot & Damper Assembly,

“L” then size for Internal Adjustable.

## Quadrants, Damper Kits & Push Pull Kits

Part #	Description	Qty Per Ctn.
82DK	H & C Damper Hardware Set (Rapid Kit) Wing Nut, Handle, Washer Spring Loaded Stub Shaft Plain Stub Shaft ** Order Top Hat separately if required **	100
82TH	Black Nylon Bearing (Top Hat)	100
82QS10	Quadrant Set – 10mm	Each
82QS12	Quadrant Set – 12mm	Each
82QSNB	Quadrant Shaft Nylon Bush (M10)	100
82QS10L	Quadrant Shaft 10mm Long	100
82QS10S	Quadrant Shaft 10mm Short	100
82OEB10	OE Bearing 10mm	Each
82OEB12	OE Bearing 12mm	Each
82CDF	Raised Quadrant Kit – Die Cast (As used in spigots)	100
82PPK	Push Pull Kits (600mm)	20





## Hinges & Catches

### BUTT HINGE STEEL Z/P

Part #	Description	Qty Per Ctn.
82BH 1.5	1.5"	24
82BH2	2"	20
82BH3	3"	24



### CATCHES

Part #	Description	Qty Per Ctn.
82SFN	Sash Fasteners ZP (2 part) Raised	100
82SFP	Sash Fasteners (2 part) Flat	100
82SFC	Sash Fastener (2 Part) Chromed.	20
82TL8022	Dzus Strike	100
82TL802B	Dzus Latch	100
82LT	Toggle Latch (2 part)	100



## CD Pins, Speedclips, Black Buttons & Self Sticks

### CD PINS

Part #	Description
232107	.105 x 3/4" Mild Steel ZP CD Pin
232110	.105 x 1" " "
232112	.105 x 1-1/4" " "
232115	.105 x 1-1/2" " "
232117	.105 x 1-1/4" " "
232120	.105 x 2" " "
232122	.105 x 2-1/4" " "
232127	.105 x 2-3/4" " "
232135	.105 x 3-1/4" " "
232137	.105 x 3-3/4" " "
232139	.105 x 4-1/4" " "

### SPEEDCLIPS Material Mild Steel Zincalume

Part #	Description
25015700	.105 x 25 x 30 (.105 x 1 x 1-1/4") round hole

### BLACK BUTTONS

Part #	Description
25200260B	.105 Nylon Black Buttons

### SELF STICK PINS Galvanized Mild Steel

Part #	Length
24500086	3/4"
24500085	1-1/4"
24500087	1-5/8"
24500090	2-1/2"

### Nail Point Pins: Insulation Pins for Polyester Insulation

232212	.105 x 1-1/4" MS Nail Point Pins
232222	.105 x 2-1/4" MS Nail Point Pins

**NOTE: CD Pins & Speedclips are available in other sizes & material upon request.**

## CD Accessories

<b>“J” TYPE CHUCK – TAPERED (Suits recent models)</b>	
<b>Part #</b>	<b>Description</b>
21014510J	.105 Standard Chuck
<b>“E” TYPE CHUCK – SCREW IN PIN CHUCK (Suits old models)</b>	
<b>Part #</b>	<b>Description</b>
21014510E	.105 Screw in Pin Chuck
<b>Copper Chucks to Suit KCD Stud welding machines</b>	
<b>Part #</b>	<b>Description</b>
21KCD105	.105 Copper Chuck Suit KCD

## Sealants, Waffle Pad & Tapes

Part No	Description	Qty per Ctn
82SP6	TDC/TDF Spray 454gm Aerosol Can	6 cans
82STC	Silicone Clear 300ml tube	25 tubes
82STG	Silicone Grey 400gm tube	25 tubes
82SFS	Firesound Silicon Grey 400gm tube	20 tubes
82SWF	Fosters 32-19 Duct Sealer <b>Water</b> Based 420gm tube	20 tubes
82SWE	Fosters 32-19 Duct Sealer 4lt tin	4 tins
82PADW450	Waffle Pad; 450 x 450 x 9mm	1
83FPE1805	"PPC" Flange Sealing Foam Tape 18mm x 5mm x 15m	16 rolls
83D48	"PPC" PVC Duct Tape 48mm x 30m	60 rolls
83R40	"PPC" Reinforced Aluminum Foil Tape 40mm x 50m	24 rolls
83R48	"PPC" Reinforced Aluminum Foil Tape 48mm x 50m	24 rolls
83R63	"PPC" Reinforced Aluminum Foil Tape 63mm x 50m	16 rolls
83R72	"PPC" Reinforced Aluminum Foil Tape 72mm x 50m	16 rolls
83R84	"PPC" Reinforced Aluminum Foil Tape 84mm x 50m	12 rolls
83R96	"PPC" Reinforced Aluminum Foil Tape 96mm x 50m	12 rolls
83R120	"PPC" Reinforced Aluminum Foil Tape 120mm x 50m	8 Rolls
83R146	"PPC" Reinforced Aluminum Foil Tape 146mm x 50m	8 Rolls
83R160	"PPC" Reinforced Aluminum Foil Tape 160mm x 50m	8 Rolls

**Other Foam Tape & tapes from the PPC range available to order.**

## Smart Band, Banding & Accessories

### Smart Band

Smart Band is a flexible banding system manufactured from Nylon 6.6  
 Smart Band is suitable for applications indoors or out.  
 With 1 size fits all there will never be any waste.  
 Totally impervious to atmospheric corrosion and resistant to most industrial solvents. Smart Band is the ultimate banding system.

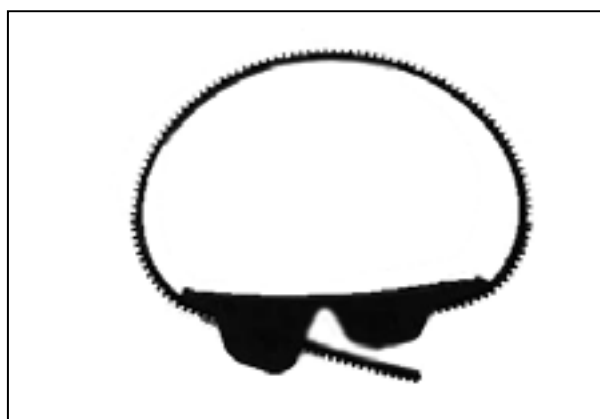

Part #	Description	Qty per Ctn
82107020	7mm Smart Band	30 Metre Reel
82107250	7mm Smart Band	250 Metre Reel
82307200	7mm Semi-Release Head	100 Pack
826A	Hand Installation Tool	1

### Banding & Buckles, Poly Strapping

Part #	Description	Qty per Ctn
82SPB12	Blue Poly Strapping 12mm	1,000 Metre
82SPF12	Plastic Buckle for Poly Strapping	1,000 Box
82SSB	9mm SS, Banding, Worm Drive	30 Metre
82SSMC	9mm SS, Buckles, Worm Drive	50 Box
82SSB25	Stud Strap Blue 25mm x 250Mtr Roll	40 Box

### ***Foil Scrim Laminate Duct Hanging Saddle***



#### **Product Construction:**

An outer layer of aluminium foil laminated to high density kraft paper with a unique extrusion polyethylene which provides a superior bond. A second layer of kraft paper is bonded with a heavy coating of flame retardant adhesive and reinforced with continuous strands of fibreglass in two directions. Another outer layer of foil is laminated with extrusion for superior bond. This material is zone coated with a strip of double sided pressure sensitive.

#### **Product Features:-**

- Provides a semi rigid, fire resistant, load distributing support system for flexible duct to meet the requirements of AS4254.1 2012 2.5.3 (d).
- It has a low flammability index (not greater than 5) in accordance with AS1530.2: 1993
- Zero Ozone Depleting Potential in both manufacture and composition.
- Adhesive strip allows the correct positioning of the saddle and prevents it moving.

<b>Part #</b>	<b>Description</b>	<b>Qty per Ctn</b>
83FS75	Flex-Saddle 75mm x 1m Mtr Roll	15 Rolls

## Dust Protection Film



Part #	Description	Qty per Ctn
836161200	Dust Protection Film 1200mm x 60Mtr Roll	4 Rolls
83616900	Dust Protection Film 900mm x 60Mtr Roll	4 Rolls
83616600	Dust Protection Film 600mm x 60Mtr Roll	4 Rolls



## Slotted Angle & Hanging Brackets

### Slotted Angle - ZP



Part #	Angle Size	Slot Size	Length
36EA3030	30 x 30 x 3	19 x 8	3 Metre
36EA5050	50 x 50 x 3	30 x 14	3 Metre

### HANGING BRACKETS

Part #	Description	Qty Per Ctn.
--------	-------------	--------------

36387600	48 x 50 x 5mm 14 mm hole	100
----------	--------------------------	-----



82BZ	Z Duct Bracket	100
------	----------------	-----





## Purlin & Beam Clamps

### Purlin Clips, Mounting Plates & Beam Clamps

#### D1 CLIPS

Part # / Description	A mm	Ø mm	Box Quantity
Corrosion Protection – <b>3</b>			
34D1M8	≤4	9	100
34D1M10	≤4	11	100
34D1M12	≤4	13	100

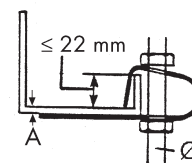

#### E2 CLIPS

Part # / Description	A mm	Ø mm	Box Quantity
Corrosion Protection – <b>3</b>			
34E2M8-TI	≤4	M8	100
34E2M10-TI	≤4	M10	100
34E2I2	≤4	M12	100
34E23/8	≤4	3/8i	100



#### CMP PLATE

Part # / Description	A mm	Ø mm	Box Quantity
Corrosion Protection – <b>1</b>			
34CMP08	N/A	M08	100
34CMP10	N/A	M10	100
34CMP12	N/A	M12	100

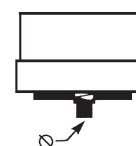

#### VMP PLATE

Part # / Description	A mm	Ø mm	Box Quantity
Corrosion Protection – <b>1</b>			
34VMP08	N/A	M08	100
34VMP10	N/A	M10	100
34VMP12	N/A	M12	100

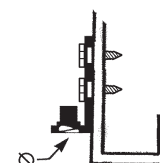

#### CENTRAL MOUNTING – MALE THREAD

Part #	Description
34MMPM10	Male Mounting Plate 10mm thread



#### HORIZONTAL MOUNTING – FEMALE THREAD

Part #	Description
34HMMP10	Horizontal Mounting Plate 10mm thread; welded socket.



#### TKN CLAMPS Z/P

Part # / Description	A mm	Ø mm	Box Quantity
Corrosion Protection – <b>1</b>			
34TKN8	18	9	100
34TKN10	20	11	100
34TKN12	26	13	80

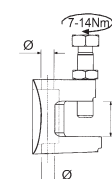

## Vertigo Hangers

For fixing direct to concrete, timber & steel trusses.

### Vertical or side hangers.

Vertigo is a one-piece all steel threaded rod hanger. It can be installed into steel truss, purlins, timber joists as well as concrete. Supports 6mm - 10mm threaded rod.

Simply insert the required Vertigo into the appropriate driver & install using a cordless drill.

### VERTICAL HANGER FOR STEEL

Part #	Description	Box Quantity
28000	6mm Rod Hanger	100
28024	8mm Rod Hanger	100
28008	10mm Rod Hanger	100

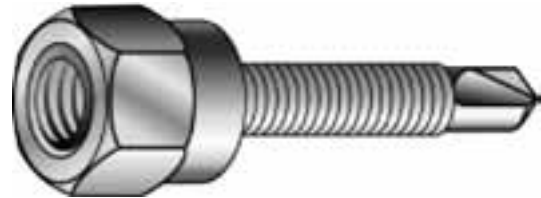

### SIDE HANGER FOR STEEL

Part #	Description	Box Quantity
28096	6mm Rod Hanger	100
28112	8mm Rod Hanger	100
28100	10mm Rod Hanger	100



### VERTICAL HANGER FOR TIMBER

Part #	Description	Box Quantity
28040	6mm Rod Hanger	100
28060	8mm Rod Hanger	100
28044	10mm Rod Hanger	100



### SIDE HANGER FOR TIMBER

Part #	Description	Box Quantity
28128	10mm Rod Hanger	100



### VERTICAL HANGER FOR CONCRETE

Part #	Description	Box Quantity
28084	10mm Rod Hanger	100

### DRIVING SOCKETS

Part #	Description	Box Quantity
287187	Timber/Steel "Red"	1
287197	Concrete "Blue"	1



## Masonry Fasteners

### STRIKE ANCHORS

Part #	Anchor Dia x Length mm	Drill Hole Dia mm	Box Quantity
Corrosion Protection – 1			
41ESA0850	8 x 50	8	60
41ESA1050	10 x 50	10	40



### SLEEVE ANCHOR HEX NUT (DYNABOLT) ZP

Part #	Anchor Dia x Length mm	Drill Hole Dia mm	Box Quantity
41485010	6.5 x 25	6.5	100
41485050	6.5 x 36	6.5	100
41485250	8 x 40	8	100
41485300	8 x 65	8	100
41485440	10 x 40	10	100
41485450	10 x 50	10	100
41485475	10 x 75	10	50
41485600	10 x 97	10	50
41485760	12 x 60	12	50



### DROP IN ANCHOR, FLANGED TYPE ZP

Part #	Anchor Dia x Length mm	Drill Hole Dia mm	Box Quantity
41525220	6 x 25	8	100
41525230	8 x 30	10	100
41525235	10 x 30	12	50
41525260	12 x 50	15	50
41525270	16 x 65	20	25



### ALL METAL DRIVE ANCHOR (METAL TAP-INS) ROUND HEAD

Part #	Anchor Dia x Length mm	Drill Hole Dia mm	Box Quantity
41545700	5 x 25	5	100
41545720	6.5 x 32	6.5	100
41545740	6.5 x 50	6.5	100



### NYLON DRIVE ANCHOR (NYLON TAP-INS) ROUND HEAD

Part #	Anchor Dia x Length mm	Drill Hole Dia mm	Box Quantity
41545540	5 x 25	5	100
41545458	5 x 40	5	100
41545560	6.5 x 25	6.5	100
41545570	6.5 x 40	6.5	100
41545580	6.5 x 50	6.5	100



### HEADLESS SCREW

#### Technical Data

Material: Steel, electro-galvanised

Part #	Type	Thread Connection	Total Length mm	Box Quantity
41585080	M10/80mm	M10 x 30	80	100
41585100	M10/100mm	M10 x 30	100	100

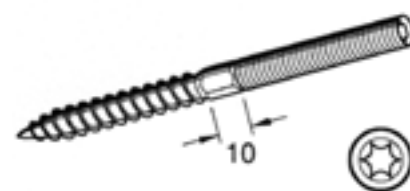

## Threaded Rod & Accessories

### Threaded Rod, Nuts, Washers, Screws & Plugs

#### THREADED ROD

Part #	Diameter	Finish	Length
42RM06	M6	ZP & HDG & SS	3m
42RM08	M8	ZP & HDG & SS	3m
42RM10	M10	ZP & HDG & SS	3m
42RM12	M12	ZP & HDG & SS	3m
42RM16	M16	ZP & HDG & SS	3m
42RM20	M20	ZP & HDG & SS	3m



#### ROD COUPLERS

Part #	Diameter	Finish
42CM06	M6	ZP & HDG & SS
42CM08	M8	ZP & HDG & SS
42CM10	M10	ZP & HDG & SS
42CM12	M12	ZP & HDG & SS
42CM16	M16	ZP & HDG & SS
42CM20	M20	ZP & HDG & SS

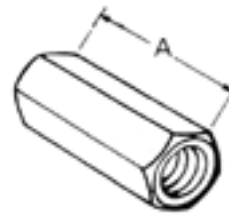

#### HEX NUTS

Part #	Diameter	Finish
42NHZM06	M6	ZP & HDG & SS
42NHZM08	M8	ZP & HDG & SS
42NHZM10	M10	ZP & HDG & SS
42NHZM12	M12	ZP & HDG & SS
42NHZM16	M16	ZP & HDG & SS
42NHZM20	M20	ZP & HDG & SS



#### FLAT WASHERS

Part #	Diameter	Finish
42WFZM06	M6	ZP & HDG & SS
42WFZM08	M8	ZP & HDG & SS
42WFZM10	M10	ZP & HDG & SS
42WFZM12	M12	ZP & HDG & SS
42WFZM16	M16	ZP & HDG & SS
42WFZM20	M20	ZP & HDG & SS



#### SPRING WASHERS

Part #	Diameter	Finish
42WSZM06	M6	ZP & HDG & SS
42WSZM08	M8	ZP & HDG & SS
42WSZM10	M10	ZP & HDG & SS
42WSZM12	M12	ZP & HDG & SS
42WSZM16	M16	ZP & HDG & SS
42WSZM20	M20	ZP & HDG & SS



#### COACH SCREWS/PLUGS

Part #	Diameter	Finish
41CS0850	M8 x 50	ZP
41CS1065	M10 x 65	ZP
41CSP1050	M10 x 50	Nylon
41CSP12060	M12 x 60	Nylon



#### FRAME ANCHOR

Part #	Description	Box Quantity
41560235	M10 x 80 C/W Plug	100
41560240	M10 x 100 C/W Plug	100



## Set Screws, Cup Heads & Metal Cutting Discs

### METRIC COMMERCIAL HEX HEAD SET SCREWS ZP

M6 x 10	M8 x 20	M10 x 20	M12 x 25
M6 x 20	M8 x 25	M10 x 25	M12 x 30
M6 x 25	M8 x 30	M10 x 30	M12 x 40
M6 x 30	M8 x 40	M10 x 40	M12 x 60
	M8 x 50	M10 x 50	M12 x 75
		M10 x 65	



### METRIC CUP HEAD MILD STEEL BOLTS & NUTS ZP

M8 x 25	M10 x 25
	M10 x 30

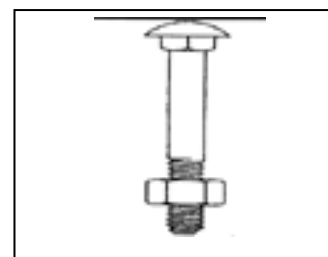

Other sizes are available on request.

Set Screws are also available in HDG & Stainless Steel.

### Metal Cutting Discs

82MCD115	115mm x 1.0mm x 22.2 Metal Cutting Disc	100 Box
82MCD125	125mm x 1.0mm x 22.2 Metal Cutting Disc	100 Box
82MCD115	356mm x 3.0mm x 25.4 Metal Cutting Disc	100 Box



## Tek Screws & Drill Bits

### SELF DRILLING FOR METAL CLASS 3

Part #	Description	Size
183308012	Hex Head	8-18x12
183310016	Hex Head	10-16x16
183310025	Hex Head	10-16x25
183312020	Hex Head	12-14x20
183312532	Hex Head Series 500	12-24x32
183310116	Hex Head w/-Neo Washer	10-16x16
183308412	Button Head	8-18x12
183310216	Wafer Head	10-16x16



### SELF DRILLING FOR METAL CLASS 2

Part #	Description	Size
183208312	Button Head	8-18x12
183208320	Button Head	8-18x20
183210216	Wafer Head	10-16x16



### SELF DRILLING FOR TIMBER CLASS 3

Part #	Description	Size
183T312025	Hex Head	12-11x25

### HSS DRILL BITS

Part #	Description	Size
15DE30	Double End	No30
15DE20	Double End	No20
15DE11	Double End	No11
15STUB30	Stub	No30
15STUB20	Stub	No20
15STUB11	Stub	No11
15JOB6.5	Jobber	6.5mm
15JOB10.5	Jobber	10.5mm



### SDS MULTI-FIT MASONRY DRILL BITS

Part #	Description	Size
152D050110	SDS Multi-Fit	M5 x 110
152D065110	SDS Multi-Fit	M6.5 x 110
152D080160	SDS Multi-Fit	M8 x 160
152D100160	SDS Multi-Fit	M10 x 160
152D120160	SDS Multi-Fit	M12 x 160
152D150160	SDS Multi-Fit	M15 x 160
152D160160	SDS Multi-Fit	M16 x 160
152D200200	SDS Multi-Fit	M20 x 200



## Pop Rivets

**Pop Rivets** Other sizes and materials are available.

### ALUMINIUM RIVETS WITH STEEL STEM

Part #	Description	Size
06AS402	3.2mm dia x 3.2 max grip	4-2
06AS403	3.2mm dia x 4.8 max grip	4-3
06AS404	3.2mm dia x 6.4 max grip	4-4
06AS604	4.8mm dia x 6.4 max grip	6-4



### ALUMINIUM SEALED RIVET

Part #	Description	Size
06TA4-3	3.2mm dia x 4.8 max grip	4-3
06SR01-4812	4.8mm dia x 8.0 max grip	6-5

### STEEL RIVETS WITH STEEL STEM

Part #	Description	Size
06SSP402	3.2mm dia x 3.2 max grip	4-2
06SSP403	3.2mm dia x 4.8 max grip	4-3
06SSP404	3.2mm dia x 6.4 max grip	4-4
06SSP504	4.2mm dia x 6.4 max grip	5-4
06SSP604	4.8mm dia x 6.4 max grip	6-4

### S/STEEL RIVETS WITH S/STEEL STEM

Part #	Description	Size
06STST402	3.2mm dia x 3.2 max grip	4-2
06STST403	3.2mm dia x 4.8 max grip	4-3
06STST404	3.2mm dia x 6.4 max grip	4-4
06STST604	4.8mm dia x 6.4 max grip	6-4

**Other sizes and materials are available.**



## Cantilever Brackets & Kits

### CANTILEVER ARM SUPPORTS

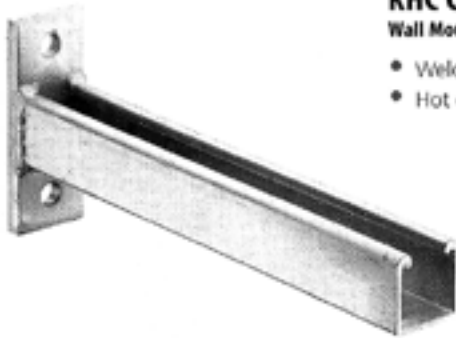

#### KHC Cantilever Arm Wall Mounting Bracket

- Welded profile 41 x 41 mm
- Hot dipped galvanised

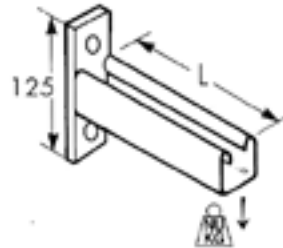

Description	Item	L mm	P	
KH150	KH10C	150	3	1
KH200	KH5C	200	3	1
KH250	KH6C	250	3	1
KH300	KH11C	300	3	1
KH400	KH15C	400	3	1
KH450	KH12C	450	3	1
KH550	KH16C	550	3	1
KH600	KH 13C	600	3	1
KH650	KH8C	650	3	1
KH700	KH9C	700	3	1
KH750	KH14C	750	3	1

#### Admissible Load Rating in kg

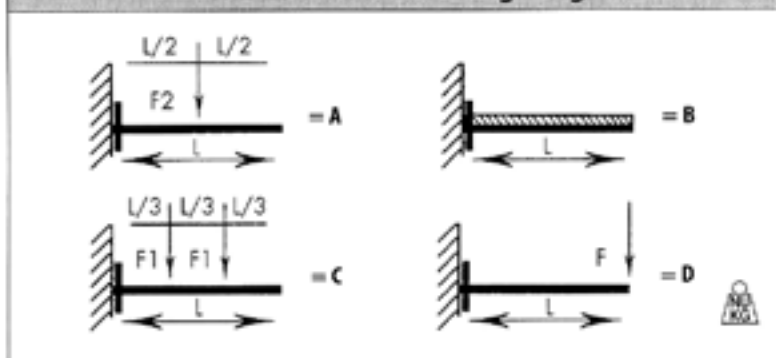

Length	A	B	C	D
150	650	650	325	325
200	480	480	240	240
250	390	390	190	190
300	325	325	162	162
400	240	240	120	120
450	217	277	108	108
550	170	170	88	88
600	162	162	81	81
650	150	150	75	75
700	140	140	70	70
750	130	130	63	63

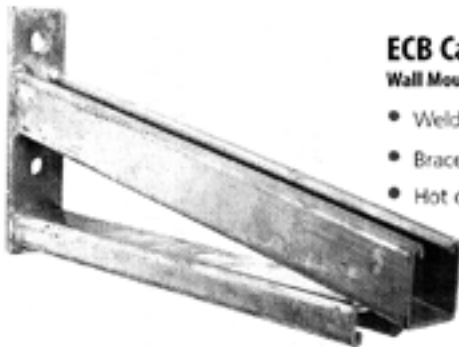

#### ECB Cantilever Arm Wall Mounting Bracket with Brace

- Welded profile 41 x 41 x 2.5 mm
- Brace profile 41 x 21 x 2.5 mm
- Hot dipped galvanised

Description	Item	L mm	P	
ECB150	ECB150	320	3	1
ECB300	ECB300	470	3	1
ECB450	ECB450	635	3	1
ECB600	ECB600	780	3	1

We stock 150, 300, 450, 600 and 750 wide in unbraced brackets. Other widths to order.

We stock 320, 470, 635 and 780 wide in braced brackets.



## Cantilever Brackets & Kits

### Unbraced

Part #	Length	Std Kit Code	Adj Kit Code
36CL150	150mm	36CL150K	36CL150KW
36CL300	300mm	CL300K	36CL300KW
36CL450	450mm	CL450K	36CL450KW
36CL600	600mm	CL600K	36CL600KW
36CL750	750mm	CL750K	36CL750KW

### Braced

Part #	Length	Std Kit Code	Adj Kit Code
36CL320B	320mm	36CL320BK	36CL320BKW
36CL470B	470mm	36CL470BK	36CL470BKW
36CL640B	635mm	36CL640BK	36CL640BKW
36CL780B	780mm	36CL780BK	36CL780BKW

### KITS COMPRISE

#### Standard Kit:

- 2 x Cantilever Bracket – choose from above
- 4 x M10 Long Spring Strut Nut
- 4 x M10 x 30 ZP Hex Head Set Screw
- 4 x M10 ZP Flat Washer
- 2 x 41 x 41 End Cap

#### Adjustable Kit:

- 2 x Cantilever Bracket – choose from above
- 4 x M10 Long Spring Strut Nut
- 4 x M10 Short Spring Strut Nut
- 4 x M10 x 25 ZP Hex Head Set Screw
- 4 x M10 x 30 ZP Hex Head Set Screw
- 8 x M10 ZP Flat Washer
- 2 x 41 x 41 End Cap
- 2 x 41 x 21 Slotted Strut x 500mm

## Channel and Accessories

### HEAVY DUTY 2.5MM THICKNESS

Part #	Size mm	Finish	Box Quantity
36ES1000-6	41 x 41 x 6 Mtr	HDG	1
36ES3300-6	41 x 21 x 6 Mtr	HDG	1
36ES1000-3	41 x 41 x 3 Mtr	HDG	1
36ES3300-3	41 x 21 x 3 Mtr	HDG	1
36ES5500-6	41 x 62 x 6 Mtr	HDG	1
36ES1001-6	41 x 82 x 6 Mtr	HDG	1
36ES1000-GB	41 x 41 x 6 Mtr	G/Bond	1
36ES3300-GB	41 x 21 x 6 Mtr	G/Bond	1
36ESS1000-6	41 x 41 x 6 Mtr	S/Steel	1
36ESS3300-6	41 x 21 x 6 Mtr	S/Steel	1

### HEAVY DUTY 2.5MM THICKNESS SLOTTED

Part #	Size mm	Finish	Box Quantity
36ES1000T-6	41 x 41 x 6 Mtr	HDG	1
36ES3300T-6	41 x 21 x 6 Mtr	HDG	1
36ES1000T-3	41 x 41 x 3 Mtr	HDG	1
36ES3300T-3	41 x 21 x 3 Mtr	HDG	1



ES1000



ES3300



ES1000T



ES3300T

### LIGHT DUTY 1.6MM THICKNESS

Part #	Size mm	Finish	Box Quantity
36ES2000-6	41 x 41 x 6 Mtr	G/Bond	1
36ES4000-6	41 x 21 x 6 Mtr	G/Bond	1



Mass: 1.20kg/m

### FIBREGLASS & ALUMINUM

Part #	Size mm	Finish	Box Quantity
36F1000-3	41 x 41 x 3 Mtr	Fibreglass	1
36A2000-6	41 x 41 x 6 Mtr	Aluminum	1
36A4000-6	41 x 21 x 6 Mtr	Aluminum	1

### CADDY CANTILEVER BRACKETS STANDARD (NO BRACE)

Part #	Size mm	Finish	Box Quantity
36CL150	150mm Long	HDG	1
36CL300	300mm Long	HDG	1
36CL450	450mm Long	HDG	1
36CL600	600mm Long	HDG	1
36CL750	750mm Long	HDG	1



### CADDY CANTILEVER BRACKETS BRACED TYPE

Part #	Size mm	Finish	Box Quantity
36CL320B	320mm Long	HDG	1
36CL470B	470mm Long	HDG	1
36CL640B	640mm Long	HDG	1
36CL780B	780mm Long	HDG	1



## Channel and Accessories

### Channel Fittings

#### CADDY CHANNEL FITTINGS

Part #	Description	Box Quantity
36387495	ZEA111	10
36387500	ZEA100	10
36387520	ZEA102	10
36387530	ZEA103	10
36387540	ZEA104	10
36387560	ZEA106	10
36387570	ZEA107	10
36387580	ZEA108	10
36387590	ZEA109	10
36387450	ZEA110	10
36388270	ZGA501	10
36387740	ZSA301	10
36387701	ZTA601	10
36387702	ZTA602	10
36388080	ZTA605	10
36313270	ZT606	10
36387750	ZUA400	10
36387760	ZUA401	10
36387600	ZWA200	100
36387620	ZWA202	10
36387650	ZWA205	10
36387670	ZWA207	10
36387690	ZWA209	10
36387890	ZWA214	10
36387900	ZWA215	10
36388400	ZZA701	10
36387720	ZZA702	10
36313870	ZZ704	10
36P11	P11000HD	10
36P13	P13000HD	10



ZTA601



ZTA605



ZZA704



ZEA100/111



ZEA102



ZEA104



ZEA106



ZEA107



ZEA108



ZEA109



ZEA110



ZGA501



ZSA301



ZUA400



ZWA214



ZZA701



ZZA702



ZWA215



ZWA200



ZT606



ZUA401



ZWA200



ZWA202



P11000HD

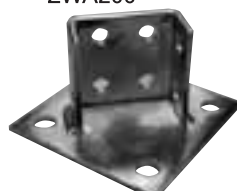

P13000HD



ZWA205



ZWA207



ZWA209

## Channel and Accessories

### Channel Nuts, Closure Strip, Caps & Trolleys

Channel Nuts also available in HDG and SS finishes.

#### CHANNEL NUTS (NO SPRING )

Part #	Size mm	Finish	Box Quantity
36NT06	M6 Trunking Nuts	ZP	100
36NN06	M6 No Spring Nuts	ZP	100
36NN08	M8 No Spring Nuts	ZP	100
36NN10	M10 No Spring Nuts	ZP	100
36NN12	M12 No Spring Nuts	ZP	100
36NN16	M16 No Spring Nuts	ZP	100



#### CHANNEL NUTS (SHORT SPRING )

Part #	Size mm	Finish	Box Quantity
36NS06	M6 Short Spring Nuts	ZP	100
36NS08	M8 Short Spring Nuts	ZP	100
36NS10	M10 Short Spring Nuts	ZP	100
36NS12	M12 Short Spring Nuts	ZP	100
36NS16	M16 Short Spring Nuts	ZP	100



#### CHANNEL NUTS (LONG SPRING )

Part #	Size mm	Finish	Box Quantity
36NL06	M6 Long Spring Nuts	ZP	100
36NL08	M8 Long Spring Nuts	ZP	100
36NL10	M10 Long Spring Nuts	ZP	100
36NL12	M12 Long Spring Nuts	ZP	100
36NL16	M16 Long Spring Nuts	ZP	100



#### PRE-MOUNTED CHANNEL NUTS

Part #	Size mm	Finish	Box Quantity
36NP08040	M8 x 40 Pre-Mounted Nut	ZP	100
36NP10040	M10 x 40 Pre-Mounted Nut	ZP	100



#### CLOSURE STRIP

Part #	Size mm	Finish	Box Quantity
36313309	Grey suit 41mm Channel	Plastic	1
36313311	Aluminium suit 41mm Channel	Aluminum	1



#### CHANNEL END CAPS

Part #	Size mm	Finish	Box Quantity
362240	Grey suit 41mm Channel	Plastic	100
3624240	Grey suit 21mm Channel	Plastic	100



#### CHANNEL TROLLEYS

Part #	Size mm	Finish	Box Quantity
362749	2 Wheel suit 41mm Channel	ZP	25
362950	4 Wheel suit 41mm Channel	ZP	25

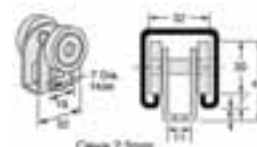





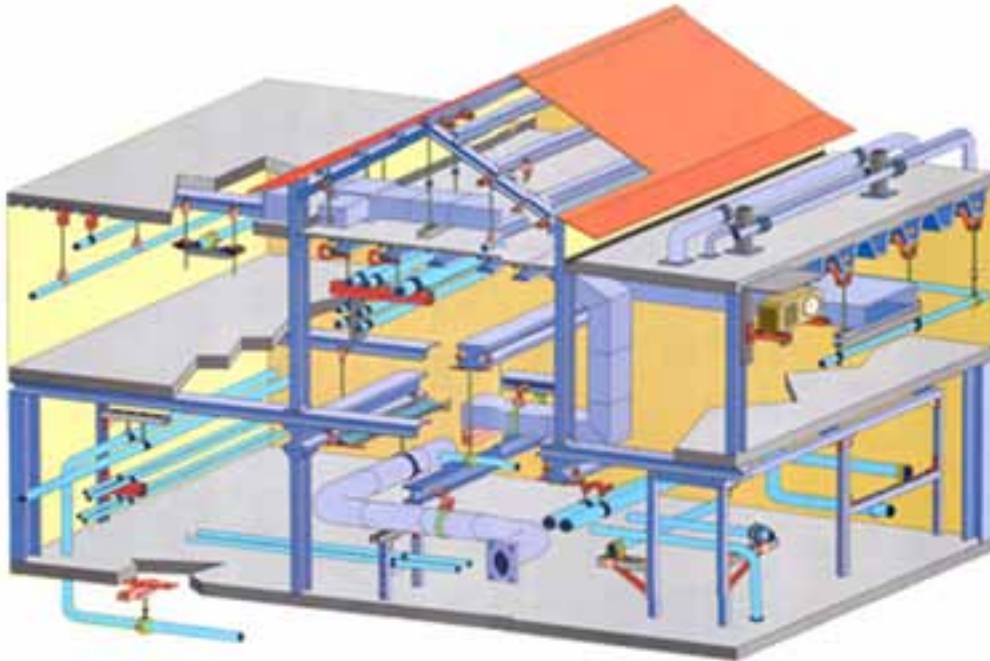

**Caddy Products "on-site" application examples**

*Delivering a Quality, Competitive Construction  
Support System on Time on Budget*



11 Cowcher Place Belmont WA 6104  
Phone: (08) 6278 7500 Fax: (08) 6278 7599  
Web Site: [www.caddyindustrial.com.au](http://www.caddyindustrial.com.au)  
Email: [sales@caddyindustrial.com.au](mailto:sales@caddyindustrial.com.au)